

LOT 1, WATER'S EDGE

\$589,000

LAKE MARTIN, AL

CREATING A SENSE OF PLACE ON LAKE MARTIN

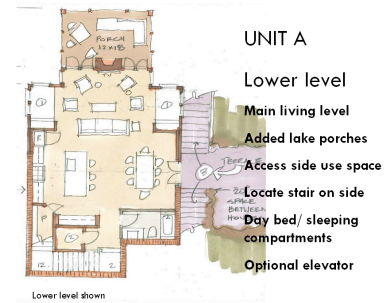

For more information
contact:

John Coley, Broker
(334) 221-5862
john@coleyre.com

LakeMartinVoice.com

w a t e r ' s
e d g e

LAKE MARTIN, ALABAMA

- 3 bedroom 3 bath home with approximately 3,200 +/- square feet over 3 stories
- Located on the **popular west side of Lake Martin** at the end of Coosa 20
- Homes is literally at the water's edge, with unparalleled miles **long views down Big Kowaliga, encompassing Willow Point, Parker Creek, Sand Island and all the way to Governor's Island.**
- Deeded boat slip on a community dock
- **Custom designed for this exact lot** by **award winning architect Bryan Jones, of Jones Pierce Architects** – Atlanta, Georgia.
- Lakeside terrace for privacy
- Optional elevator
- Creative spaces with multiple uses inside the home allows the home to live large